

IMPORTANT - CARE OF YOUR PRODUCT

AFTER INSTALLATION

After installation we strongly recommend that the fitting be securely covered to prevent contamination or damage by any form of building materials such as paint, plaster, tile adhesive, grout or sealants until all building and finishing work is completed.

CLEANING

After use all finishes should be maintained by wiping with a soft, damp, clean cloth and then polished using a soft dry duster. **NO** abrasive powder, detergents or polishes should be used, cleansers containing alcohol, acid or corrosive chemicals should **NOT** be used.

NOTE

Some household bleaches and denture cleaners can damage plated or coloured finishes and if spilt on to a fitting should be washed off immediately with cold water.

If these instructions are followed we believe this fitting will give many years of satisfactory use.

We have a policy of continuous improvement and reserve the right to change specifications without notice.

Please retain this document for future reference.

If you have any comment regarding these fittings and instructions we invite you to write to:

The Managing Director
Marflow Engineering Limited
Britannia House
Austin Way, Hamstead Industrial Estate
Birmingham, B42 1DU

© 2004 Marflow Engineering Limited. All rights reserved. No part of this publication may be reproduced, photocopied, stored on a retrieval system, or transmitted without the express written permission of Marflow Engineering Limited.

INSTALLATION AND USER INSTRUCTIONS

Item	Slide rail kit with handset and integral inlet
Date	Feb 2008
Ref.	SKC157

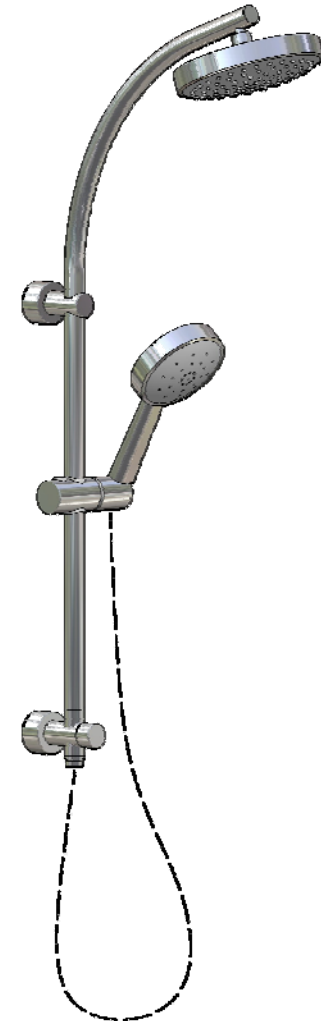

Marflow

Guaranteed.
Manufactured under BSI Registered International Quality System BS EN IS9001:2000
Certificate number : FM57646

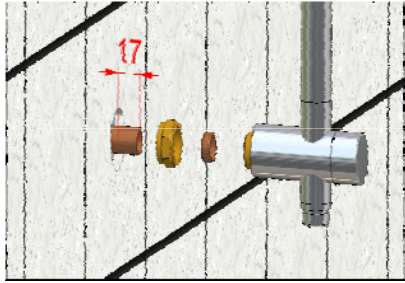

1 After positioning riser kit, finished wall should be prepared with a securely fixed 17mm protruding, length of 15mm diameter copper tube.

2 Flush pipework to remove any debris.



3 Top bracket should be fixed with wall plug and screw provided.



4. Fit riser kit to top bracket and protruding copper tube, ensuring top and bottom sliding covers are in position, and compression nut and ring are fitted.

5 Tighten compression nut.



6 Fix to top bracket with grub screw using hexagon key provided.

7 Test operation and check for leaks.

8 Hole around copper tube can now be sealed with a suitable sealant.

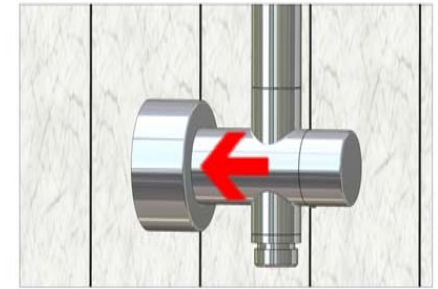

9 Push top & bottom sliding covers back to finished wall surface.

10 Fit hose, handset and overhead shower rose ensuring washer seals are included.